

Beginning at a Walnut  
Course & Distance  
North 11 1/2  
N18W 16 a Post  
N72E 8 3/4 Post  
S18E 25  
S54W 13 Walnut  
The place of Beginning

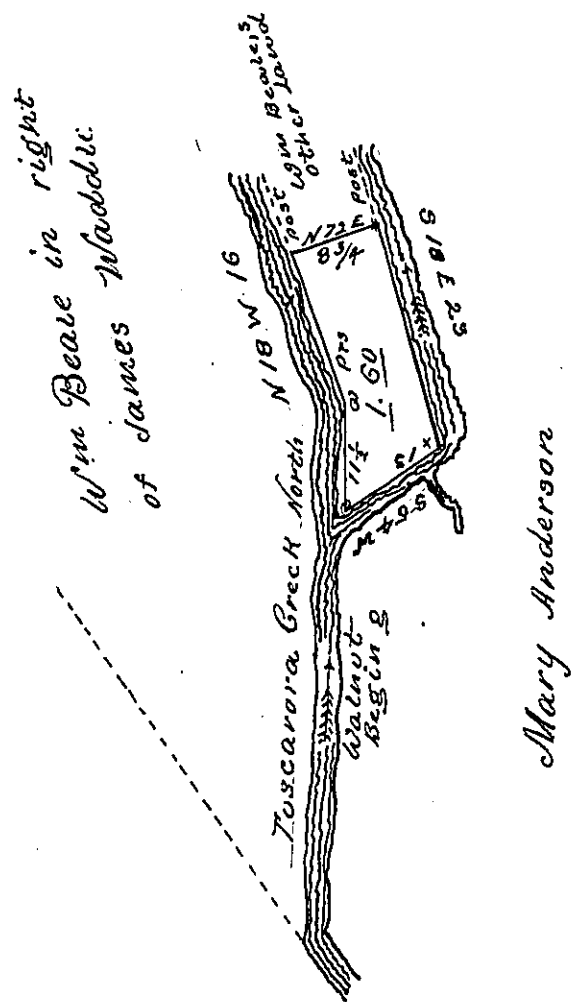

Brought of a Tract of Land containing one Acre and Sixty Perches and the Allowance of Six Per Cent for roads &c Part of an Island situate in Tuscarora Creek Milford Township Mifflin County Survey April the 25th 1804 — In pursuance of a Warrant granted to William Beale dated the 13th day of ~~March~~ February 1804 — for vacant and unimproved Land — and also agreeable to an Act of Assembly Passed the 9th day of March 1796 — Entitled an Act to Compensate David Mead and others

Note almost all the above Described piece of Land appears Cleared and under Cultivation (said to be by Wm Beale the present Claimer) yet no dwelling House or place of Residence appears there on

Pr. William Harris D.S.

To Samuel Cochran Esquire  
Surv. Gen. of Pennsylvania

IN TESTIMONY that the above is a copy of the original remaining on file in the Department of Internal Affairs of Pennsylvania, made conformably to an Act of Assembly approved the 16th day of February, 1833, I have hereunto set my Hand and caused the Seal of said Department to be affixed at Harrisburg, this Twenty Third day of November 1903

*Grace D. Brown*  
Secretary of Internal Affairs.